

VIKING Service Information for MODEL RC-218

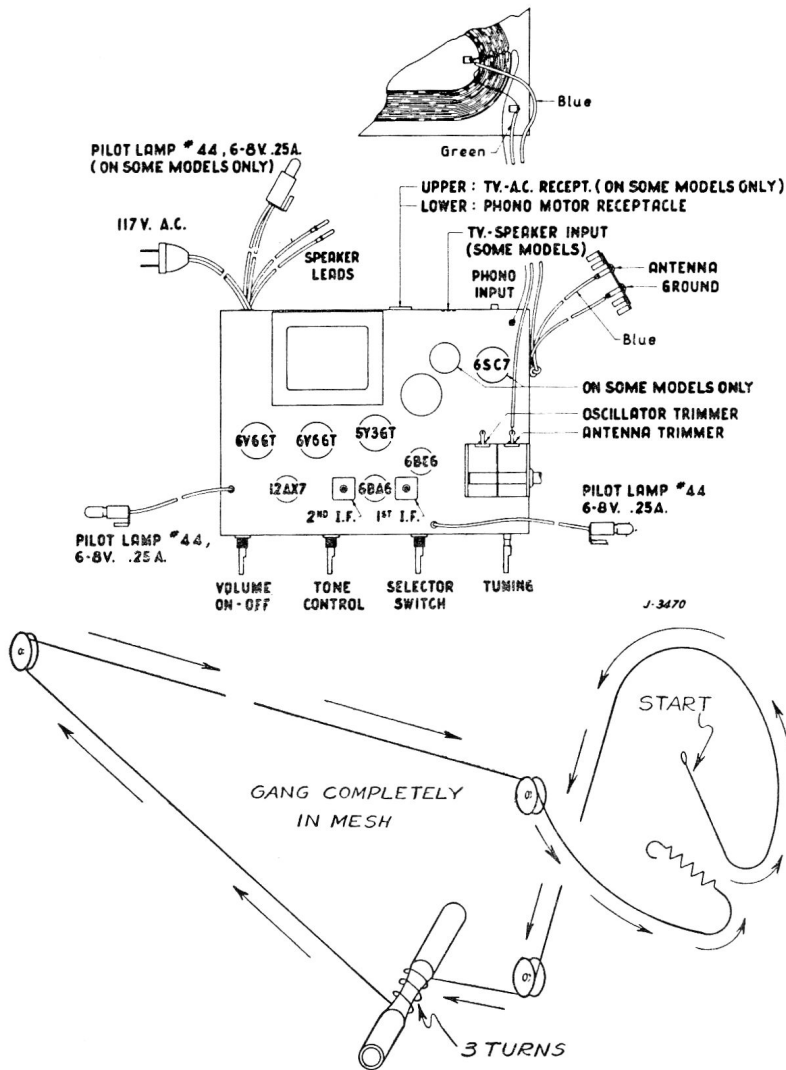

STRINGING DETAIL

FOR Operation on 110-120 Volts A.C. — Cycle as listed on License Plate.

SERVICE REPLACEMENT PARTS LIST

A-2709.....Glass Dial Scale
 B-4285-3.....Drive Shaft
 G-504.....Dual Electrolytic 40 & 20 ufd at 450 W.V.
 G-531.....Dual Electrolytic 15 & 15 lfd at 150 W.V.
 K-771A.....Pilot Lamp No. 44, .25 Amp. 6-8 Volt
 K-875-1.....Phono Socket
 K-923.....AC. Receptacle
 LK-515-2.....Output Transformer
 Power Transformer—
 60 cycle, LK-453-4
 25 cycle, LK-452-4
 MP-1204-46...Pointer & Slider Assy.
 P-2438-1.....BC. Oscillator Coil
 P-2485R.....I.F. Transformer (1st. & 2nd.)
 P-2519.....Loop Ant. Assy.

Q-299-3.....Selector Switch
 R-339-3.....Volume Control & AC. Switch
 R-371-4.....Tone Control
 V-372-4.....Gang Cond. & Drum Assy.

INSTALLATION

C-835.....Record Adapter Insert
 K-1639.....Coaxial Speaker
 N-348-3.....Knob (Plastic), Push-on Type
 N-356-2.....Knob (Plastic) Selector Switch

AUTOMATIC RECORD CHANGER

P-2786-1Webster Model 140, 60 cycle Record Changer, complete
 P-2787-1Webster Model 140, 25 cycle Record Changer, complete
 Sonotone No. 9980S Ceramic Cartridge.

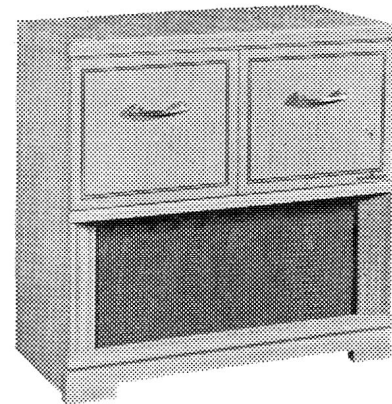

SPECIFICATIONS

Standard Broadcast Range 535 Kc — 1650 Kc
 Intermediate Frequency 455 KC.
 Power Consumption (Radio Only) 70 Watts
 Power Consumption (Radio and Phono) 85 Watts
 Undistorted Output 6 Watts
 Maximum Power Output 9 Watts

When writing for Service Information or Parts please quote Model Number Serial Number and finish of cabinet.

FOR ALIGNMENT AND SENSITIVITY DATA SEE SCHEMATIC

THE T. EATON CO. LIMITED
 C A N A D A

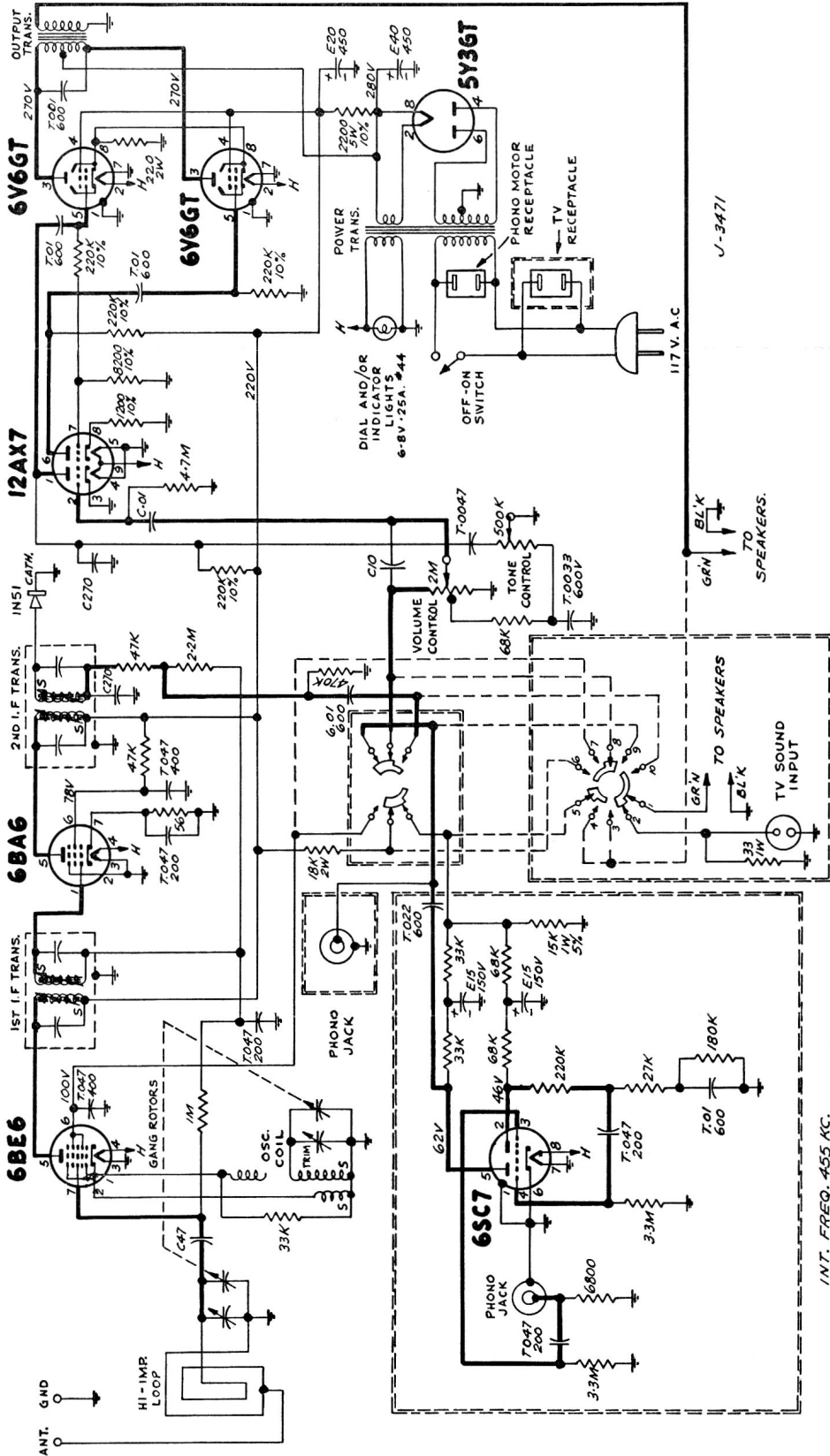

J-3471

STEP	SIGNAL GENERATOR MODULATED 30% AT 400 CY.		ADJUST FOR NOMINAL SENSITIVITY	MAX OUTPUT FOR 500 MILLIWATTS OUTPUT
	APPLY SIGNAL AT KC.	THRU SERIES DUMMY AT		
1	455	6BA6 #1 PIN	2ND I.F. (IRON CORES)	3400 μ V
2	455	6BE6 #1 PIN	1ST I.F. (IRON CORES)	90 μ V
3	1460	6BE6 #7 PIN	OSC. TRIM	—
4	1460	ANT.	B.C. ANT. TRIM	120 μ V/M
5	600	ANT.	600 KC.	320 μ V/M

COMPONENT VALUES

RESISTORS: HALF WATT, UNLESS OTHERWISE NOTED.
20% TOLERANCE, UNLESS OTHERWISE NOTED.
K = 1000 OHMS.
M = 1000,000 OHMS.

CONDENSERS: T = TUBULAR, FOLLOWED BY CAP. IN MMFD. AND D.C. IN V.
E = ELECTROLYTIC, FOLLOWED BY CAP. IN MMFD. EDC. IN V.
C = CERAMIC, FOLLOWED BY CAP. IN MMFD. FOL. IF CRITICAL.
M = MICR., FOLLOWED BY CAP. IN MMFD. FOL. IF CRITICAL.

ALIGNMENT AND SENSITIVITY

INT. FREQ. 455 KC.	ALIGNMENT AND SENSITIVITY
455	ADJUST FOR NOMINAL SENSITIVITY
1460	B.C. ANT. TRIM
600	600 KC.

ALL DETAILS SHOWN IN DOUBLE OUTLINED SECTIONS ARE USED ON SOME MODELS ONLY.

* FASHION LOOP OF SEVERAL TURNS OF WIRE AND RADIATE SIGNAL INTO LOOP OF RECEIVER. ADJUST FOR MAXIMUM OUTPUT.

TV - PHONO - RADIO SWITCH SHOWN IN TV (COUNTERCLOCKWISE) POSITION.

C.N.	DATE	C. CHANGE	SYMB.	CK.